

T-Connectors

FBT Bar Run - Tubing Tap

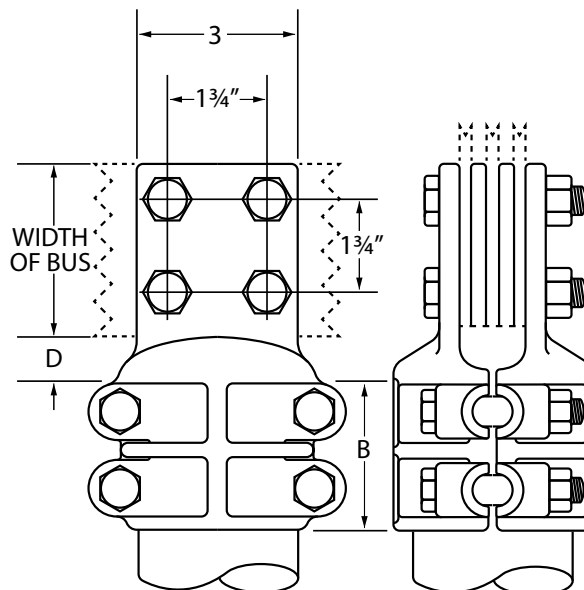
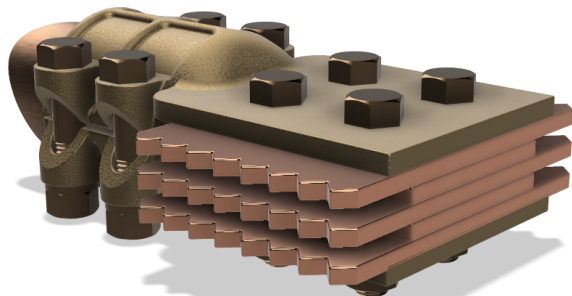

For making a tubular tap from flat bars. Cast in interchangeable halves to facilitate installation. Fittings are listed for use with 14 inch thick flat bars. If bars of other thicknesses are to be used, specify on order.

I.P.S. TUBE	NUMBER OF BARS	WIDTH OF BARS	CATALOG NUMBER	DIMENSIONS IN INCHES		BOLT DIAMETER	
				B	D	RUN	TAP
2	1	3	FBT-130	3	1 3/16	1/2	1/2
2	1	4	FBT-131	3	1 1/8	1/2	1/2
2	2	3	FBT-132	3	1 1/8	1/2	1/2
2	2	4	FBT-133	3 1/2	1 1/8	1/2	1/2
2	3	4	FBT-134	3 1/2	1 1/8	1/2	1/2
2 1/2	1	3	FBT-140	2 3/4	1 1/8	1/2	1/2
2 1/2	1	4	FBT-141	2 3/4	1 1/8	1/2	1/2
2 1/2	2	3	FBT-142	2 3/4	1 1/8	1/2	1/2
2 1/2	2	4	FBT-143	2 3/4	1 1/8	1/2	1/2
2 1/2	3	3	FBT-144	2 3/4	1 1/8	1/2	1/2
2 1/2	3	4	FBT-145	2 3/4	1 1/8	1/2	1/2
3	1	3	FBT-150	3 1/2	1 1/8	1/2	1/2
3	1	4	FBT-151	3 1/2	1 1/8	1/2	1/2
3	2	3	FBT-152	3 1/2	1 1/8	1/2	1/2
3	2	4	FBT-153	3 1/2	1 1/8	1/2	5/8
3	3	3	FBT-154	3 1/2	1 1/8	1/2	5/8
3	3	4	FBT-155	3 1/2	1 5/8	1/2	5/8
3	4	4	FBT-156	3 1/2	1 1/8	1/2	5/8
3 1/2	1	4	FBT-160	3 1/2	1 1/8	1/2	5/8
3 1/2	2	3	FBT-161	3 1/2	1 3/4	1/2	5/8
3 1/2	2	4	FBT-162	3 1/2	1 1/8	1/2	5/8

(continued)

For cross reference or other information, please contact us.
deltastarcc.com



DELTA STAR
CONNECTOR COMPANY



T-Connectors

FBT Bar Run - Tubing Tap

(continued)

I.P.S. TUBE	NUMBER OF BARS	WIDTH OF BARS	CATALOG NUMBER	DIMENSIONS IN INCHES		BOLT DIAMETER	
				B	D	RUN	TAP
3 1/2	3	3	FBT-163	3 1/2	1 1/8	1/2	5/8
3 1/2	3	4	FBT-164	3 1/2	1 1/8	1/2	5/8
3 1/2	4	3	FBT-165	3 1/2	1 3/4	1/2	5/8
3 1/2	4	4	FBT-166	3 1/2	1 1/8	1/2	5/8
4	2	3	FBT-170	3 1/2	1 1/8	1/2	5/8
4	2	4	FBT-171	3 1/2	1 1/8	1/2	5/8
4	3	3	FBT-172	3 1/2	1 1/8	1/2	5/8
4	3	4	FBT-173	3 1/2	1 1/8	1/2	5/8
4	4	3	FBT-174	3 1/2	1 1/8	1/2	5/8
4	4	4	FBT-175	3 1/2	1 1/8	1/2	5/8

For cross reference or other
information, please contact us.
deltastarcc.com



**DELTA STAR
CONNECTOR COMPANY**

